

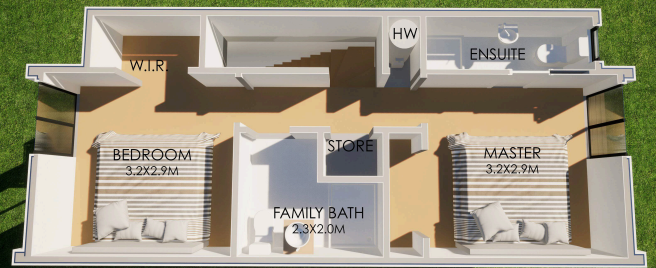

## COMFORTABLE AND AFFORDABLE HOMES



GROUND FLOOR PLAN



FIRST FLOOR PLAN



2



2



70 m<sup>2</sup>



**JAPAN HOMES**

Unit A, 65 View Road, Wairau Valley, Auckland

Phone: 0800-00-5055

Email: [info@japanhomes.co.nz](mailto:info@japanhomes.co.nz)

Web: <https://japanhomes.co.nz>



This charming 2-storey townhouse is a perfect fit for a new start family or first home buyer looking for a comfortable and functional living space. The townhouse features an open plan living, dining, and kitchen area on the ground floor, providing an ideal space for entertaining guests or spending quality time with family. The second floor of the townhouse hosts two cozy bedrooms, including a master bedroom with an ensuite bath, offering a private sanctuary for relaxation and rest. The second bedroom is perfect for children or guests, and both bedrooms feature large windows, allowing plenty of natural light to flow in.

Additionally, a family bath is located on the first floor, providing convenience and easy access for guests and residents alike.

Overall, this townhouse is an excellent choice for anyone looking for a comfortable and functional living space. With its open plan layout, modern amenities, it is the perfect place to call home.

この魅力的な2階建てのタウンハウスは、快適で機能的な生活空間を求める新しい家族や初めての住宅購入者にぴったりの物件です。1階にはオープンプランのリビング、ダイニング、キッチンエリアがあり、ゲストを招待したり、家族との質の高い時間を過ごすのに理想的なスペースを提供します。2階には、マスターベッドルームに続く ensuite バスルームを備えた居心地の良い2つのベッドルームがあり、リラックスや休息に最適なプライベートな空間を提供します。2番目のベッドルームは、子供やゲストに最適で、両方のベッドルームには大きな窓があり、自然光が豊富に入ります。

また、ファミリーバスルームは1階にあり、ゲストや住民にとって便利で簡単にアクセスできます。

全体的に、このタウンハウスは快適で機能的な生活空間を求める人にとって優れた選択肢です。オープンプランのレイアウトとモダンな設備があり、まさに理想の家と言えます。

这座新式的双层联排别墅非常适合新成家的家庭或首次置业者寻找舒适实用的居住空间。别墅的一楼是开放式的起居、餐厅和厨房区域，为招待客人或与家人共度美好时光提供了理想的空间。别墅的二楼有两间舒适的卧室，其中包括一个带有套间浴室的主卧室，为放松和休息提供了私密的空间。第二间卧室非常适合儿童或客人，两间卧室都配有大窗户，充分利用自然光线。

此外，别墅的一楼还设有一个家庭浴室，为客人和居民提供方便和易于访问的设施。

总的来说，这座联排别墅是寻找舒适实用居住空间的任何人的绝佳选择。凭借其开放式的布局和现代化的设施，这里是您完美的家园。

**Disclaimer:**

1. The floor plan and 3D rendering image included in this brochure are intended to provide a visual representation of the property's layout and design. They are for illustrative purposes only and may not be drawn to scale. Actual dimensions, finishes, fixtures, and fittings may vary from those depicted in the images.
2. The property brochure, including the floor plan and 3D rendering image, is not intended to be a legally binding document. We reserves the right to make variations, modifications, and improvements to the property, its design, specifications, and features at any time without prior notice.
3. This property brochure does not constitute legal, financial, or investment advice.
4. The availability and pricing of the property mentioned in this brochure are subject to change without notice.

